



Purchasing Department

209 Water Street
Johnson City, TN 37601
(423) 975-2716

ADDENDUM

TO: All Prospective Vendors

FROM: Debbie Dillon,
Director of Purchasing

SUBJECT: Addendum No. 2 ITB #6468
Classroom Additions to Woodland Elementary School

DATE: December 11, 2020

Consider this addendum an integral part of the above referenced Invitation to Bid:

Reference 7 page addendum notice from BLS Thompson & Litton.

All other specifications/requirements remain the same. **Vendor to acknowledge receipt of this addendum on the bid form. Please contact this office if your response has already been submitted.** Failure to acknowledge this addendum could be cause for rejection of your submittal. Your un-opened response envelope can be returned to you for re-submittal upon request. Any questions regarding addendum submittal please contact this office.

/dd



ADDENDUM NO. 02

TO: All Plan Holders

RE: Johnson City Schools – Classroom Additions to Woodland Elementary School ITB #6468
T&L Project No. 15165

DATE: December 11, 2020

BIDS RECEIVED DATE: December 17, 2020 2:00 PM

This Addendum forms a part of the Contract Documents and modifies the original Bidding Documents. Acknowledge receipt of this Addendum in the space provided on the Bid Form. Failure to do so may subject Bidder to disqualification.

PROJECT MANUAL AND SPECIFICATIONS

1. Refer to Section 01 2100 ALLOWANCES, 1.5 A.: ADD Trane is including the Mitsubishi mini-splits in their scope, quantity (1) DS-1 and qty (3) DS-2. They are not listed on the original scope proposal, but are included in the price, so allowance pricing for Trane items will not change. Refrigerant line sets, refrigerant specialties, disconnects, power wiring and external vibration isolation are not included.
2. Refer to Section 05 1200 STRUCTURAL STEEL FRAMING, 1.5 B: B. REVISE AS FOLLOWS: Fabricator Qualifications: Work fabricated by an AISC Certified Structural Steel Fabricator, shall be in accordance with AISC 207, Category BU. AISC Structural Steel Fabricator quality certification shall be submitted with structural steel shop drawings. Work fabricated by Structural Steel Fabricator that is not AISC Certified shall be in accordance with paragraph 1.5 A., and the steel fabrication shall be observed and inspected in accordance with Section 01 4533 CODE REQUIRED SPECIAL INSPECTION AND PROCEDURES.
3. Refer to Section 09 6510 LUXURY VINYL TILE FLOORING, specifically to Part 2.5. Where Moisture Shield is called to be used, the use of Shaw Surface Prep EXT will be required as per manufacturer's recommendation.
4. Refer to Section 09 6530 SAND CUSHION TERRAZZO: DELETE this section and REPLACE with the attached Section 09 6613 - PORTLAND CEMENT TERRAZZO FLOORING
5. Refer to spec. section 23-8114 page 6 "High Efficiency Filters-MERV 8 and the Rooftop Schedule on drawing M-1: Omit the requirement for MERV 8 filters and substitute in MERV 13 filters. Provide an initial set of filters for use when the units are started and a second set to be changed in each unit when substantial completion is obtained for that phase of work.
6. Refer to Section 23 3113 METAL DUCTWORK 3.7: Ductwork shall be cleaned according to this specification.

continues next page



DRAWINGS

1. Refer to Drawing sheet A-5 Details 2/A-5, 3/A-5 and 4/A-5. Terrazzo shall be monolithic terrazzo. Refer to details in attached drawings AD2-1 and AD2-2
2. Refer to Drawing sheet M-3 Corridors E142 and E154. Supply grilles located in corridors shall be fire rated.
3. Refer to Drawing M-10 Rooms A121 and B109 Janitor. Provide 8x8 EER return with gypsum board ceiling trim.

ATTACHMENTS

Section 09 6613 - PORTLAND CEMENT TERRAZZO FLOORING

Drawings AD2-1 and AD2-2

END OF ADDENDUM TWO

SECTION 09 6613 - PORTLAND CEMENT TERRAZZO FLOORING

PART 1 GENERAL

1.1 SECTION INCLUDES

- A. Cast-in-place terrazzo floor.
- B. Divider strips and termination edging.

1.2 REFERENCE STANDARDS

- A. ASTM C33/C33M - Standard Specification for Concrete Aggregates 2018.
- B. NTMA (SPECS) - NTMA Terrazzo Specifications Current Edition.

1.3 SUBMITTALS

- A. See Section 01 3000 - Administrative Requirements, for submittal procedures.
- B. Product Data: Provide data for divider strips, expansion joints, and sealer; include printed copy of current NTMA recommendations for the type of terrazzo specified.
- C. Shop Drawings: Indicate divider strip layout and details of adjacent components.
- D. Samples: Submit two samples, 6 by 6 inch (150 by 150 mm) in size illustrating color, chip size and variation, chip gradation, mortar color, and typical divider strip.
- E. Cleaning and Maintenance Data: Include procedures for stain removal, stripping, and sealing.

1.4 MOCK-UP

- A. Construct mock-up of terrazzo flooring illustrating appearance of finished work. Size mock-up to be not less than 3 by 3 feet (1 by 1 m).
- B. Locate mock-up where directed.
- C. Mock-up may remain as part of the Work.

1.5 FIELD CONDITIONS

- A. Do not install terrazzo when temperature is below 50 degrees F (10 degrees C) or above 90 degrees F (32 degrees C).
- B. Maintain temperature within specified range 24 hours before, during, and 72 hours after installation of terrazzo.
- C. Provide ambient lighting level of 50 ft candles (540 lx), measured at floor surface.

PART 2 PRODUCTS

2.1 PORTLAND CEMENT TERRAZZO APPLICATIONS

- A. Floors: Monolithic Terrazzo.
 - 1. Color(s): Match existing.

2. Aggregate Type: Marble chips.
3. Aggregate Size: No. 1 and 2. in equal parts (50/50%)

2.2 PORTLAND CEMENT TERRAZZO FLOORING

A. Materials:

1. Portland Cement: ASTM C150/C150M, Type I Normal; white color for topping mix; modified to NTMA higher compressive strength requirements; obtained from single source.
2. Terrazzo Sand: ASTM C33/C33M fine aggregates.
3. Water: Potable.
4. Surface Aggregate: Marble, free of deleterious or foreign matter.

B. Accessories:

1. Divider Strips: 1/8 inch (3 mm) thick zinc exposed top strip, zinc coated steel concealed bottom strip, with anchoring features.
2. Control Joint Strips: 1/8 inch (3 mm) nominal width zinc exposed top strips, zinc coated steel concealed bottom strip, 1/8 inch (3 mm) wide neoprene filler strip between vertical strips, with anchoring features.
3. Divider and Control Joint Strip Height: To suit thickness of terrazzo topping, with allowance for grinding.
4. Foam Filler: Closed cell urethane foam, capable of compression to 50 percent of its thickness with full recovery.
5. Cleaner: Neutralizing liquid type, pH of 7 to 10.
6. Sealer: Colorless, non-yellowing, penetrating liquid type, pH of 7 to 10; not detrimental to terrazzo components.

PART 3 EXECUTION

3.1 EXAMINATION

- A. Verify that substrate surfaces are ready to receive work.
- B. Do not begin terrazzo work until concrete substrate has cured 28 days, minimum, and has dried to a maximum moisture content of 12 percent.

3.2 PREPARATION

- A. Clean substrate of foreign matter.
- B. Remove loose or flaking concrete and repair to form sound, solid substrate.
- C. Remove surface water and thoroughly brush in neat cement slurry bond coat.

3.3 APPLICATION - MONOLITHIC TERRAZZO

- A. Saw cut concrete slab on grade to receive divider and control joint strips and inserts and fill with grout.
- B. Install strips straight and level to locations indicated.
- C. Place terrazzo topping mix over slurry coated substrate to a nominal thickness of 1/2 inch (12 mm).

3.4 CURING

- A. Begin curing procedures as soon as curing materials can be applied without damaging formed surfaces.
- B. Use curing method in accordance with NTMA instructions.
- C. Close area to construction traffic, allowing undisturbed curing.

3.5 SURFACE FINISHING

- A. Brush apply terrazzo topping mix slurry to topping surface.
- B. Finish terrazzo in accordance with NTMA instructions.
- C. Grind terrazzo surface with power disc machine; successively sequence using coarse to fine grit abrasive, using a wet method.
- D. Apply grout mix matching matrix color to fill honeycomb exposed during grinding.
- E. After grout has sufficiently cured, grind repaired areas using a fine grit abrasive.

3.6 CLEANING

- A. Scrub and clean terrazzo surfaces with cleaner in accordance with NTMA instructions. Let dry.
- B. Seal and polish surfaces in accordance with NTMA instructions.

3.7 PROTECTION

- A. Do not permit construction traffic over finished terrazzo surfaces.

END OF SECTION

PROJECT NO. 15165	DATE 12-8-2020
----------------------	-------------------

CLASSROOM ADDITIONS TO
WOODLAND ELEMENTARY SCHOOL
 JOHNSON CITY, TENNESSEE

PARTIAL GRADING AND DRAINAGE PLAN



AD2-1

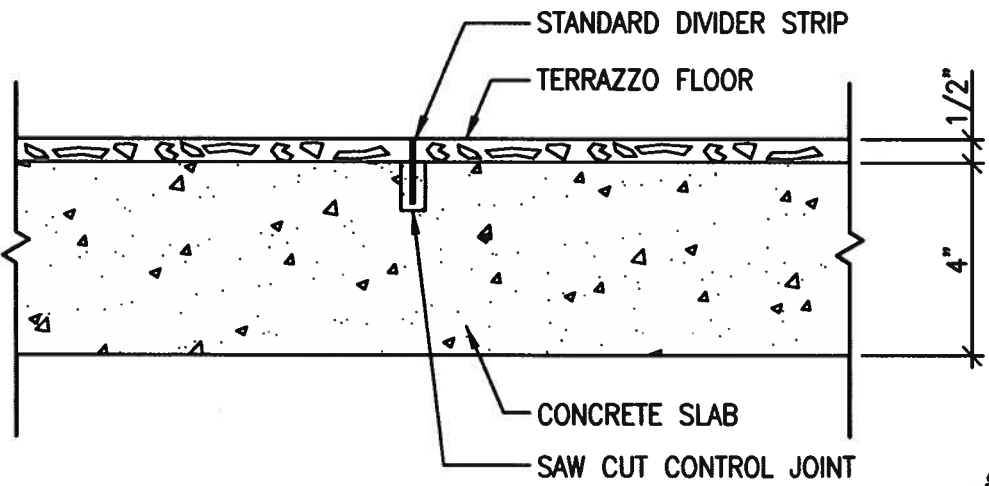

1 TERRAZZO CONTROL
 AD2-1 JOINT SCALE: 3"=1'-0"

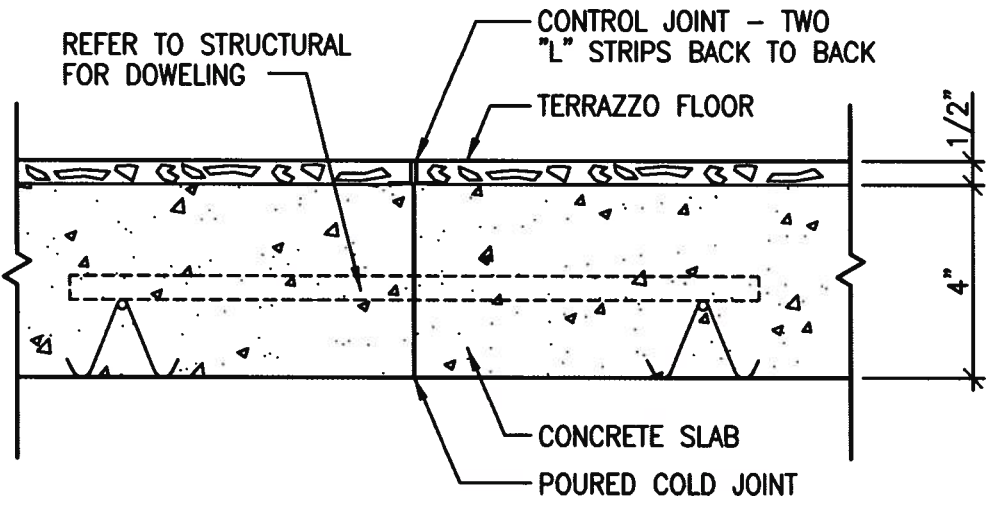
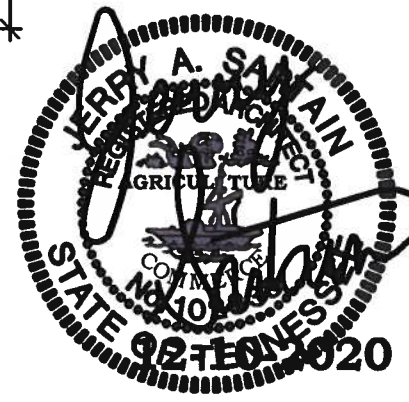

2 TERRAZZO COLD
 AD2-1 JOINT SCALE: 3"=1'-0"

PROJECT NO. 15165	DATE 12-8-2020

CLASSROOM ADDITIONS TO
WOODLAND ELEMENTARY SCHOOL
 JOHNSON CITY, TENNESSEE
 PARTIAL GRADING AND DRAINAGE PLAN



AD2-2

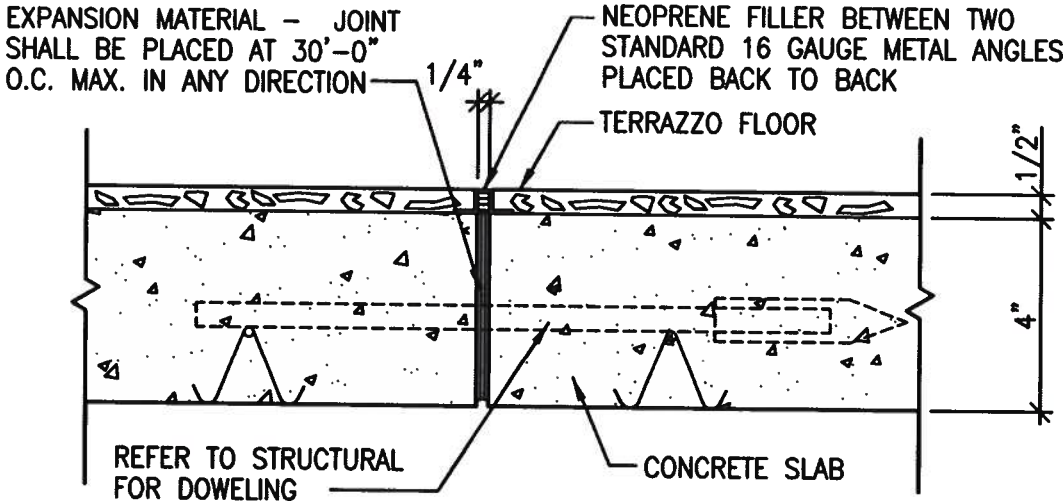

1 TERRAZZO EXPANSION
AD2-2 JOINT SCALE : 3" = 1'-0"