

**ORDINANCE NO. 4689-19**  
**(SEE COOPER ANNEXATION RESOLUTION)**

AN ORDINANCE TO AMEND THE ZONING MAP OF THE CITY OF JOHNSON CITY, TENNESSEE BEING PART OF THE APPENDIX TO ORDINANCE NO. 1519 ENTITLED "AN ORDINANCE TO ADOPT A CODE OF LAWS AND ORDINANCES FOR THE CITY OF JOHNSON CITY, TENNESSEE, AND TO REPEAL ALL LAWS AND ORDINANCES IN CONFLICT THEREWITH", AND AMENDATORY THEREOF, BY ASSIGNING A R-4 (MEDIUM DENSITY RESIDENTIAL) TO CERTAIN PROPERTY WITHIN THE ELEVENTH (11<sup>TH</sup>) CIVIL DISTRICT OF WASHINGTON COUNTY, TENNESSEE KNOWN AS THE "COOPER ANNEXATION".

---

**BE IT ORDAINED BY THE CITY OF JOHNSON CITY AS FOLLOWS:**

**SECTION 1.** That the Zoning Map of the City of Johnson City, Tennessee, being a part of the appendix to Ordinance No. 1519 entitled, "An Ordinance to Adopt a Code of Laws and Ordinances for the City of Johnson City, Tennessee, and to Repeal All Laws and Ordinances in Conflict Therewith," and all ordinances supplementary thereto and amendatory thereof, be and the same is hereby amended and modified by assigning the zoning on the following described property of a R-4 (Medium Density Residential) District.

See descriptions marked "Exhibit 'A'" and "Exhibit 'B'"

**SECTION 2. BE IT FURTHER ORDAINED,** That all ordinances and parts of ordinances in conflict herewith be and the same are hereby repealed.

**SECTION 3. BE IT FURTHER ORDAINED,** That this ordinance shall take effect from and after its passage on third and final reading and publication as required by law, the public welfare requiring it.

PASSED ON FIRST READING	<u>5-02-2019</u>
PASSED ON SECOND READING	<u>5-16-2019</u>
PASSED ON THIRD READING	<u>6-06-2019</u>

APPROVED AND SIGNED IN OPEN MEETING  
ON THE 6th DAY OF June, 2019

/s/ Jenny Brock

MAYOR

**ATTEST:**

/s/ Janet Jennings

**City Recorder**

**APPROVED AS TO FORM:**

/s/ Sunny Sandos

**Staff Attorney**

---

**“EXHIBIT ‘A’”  
Map of Property**

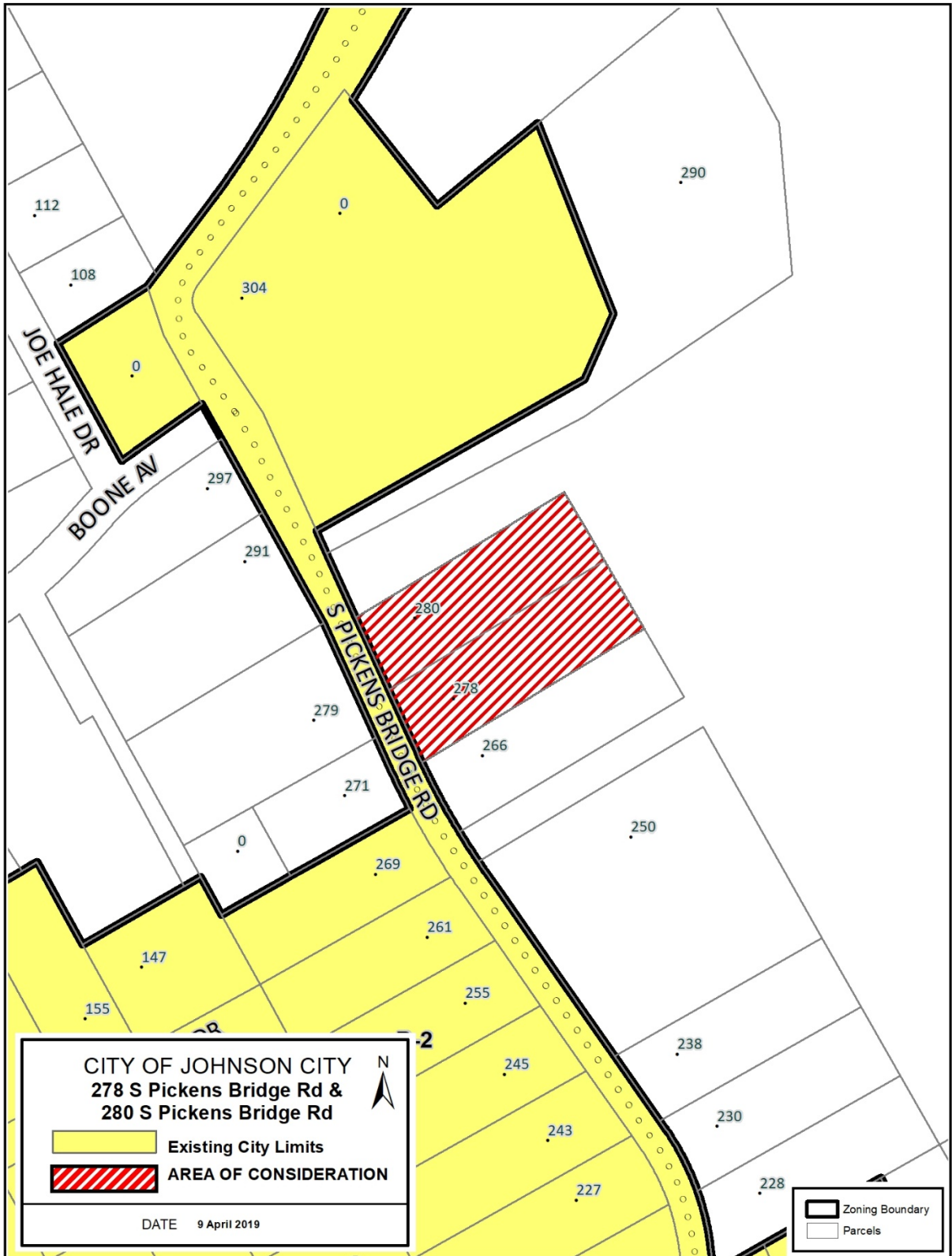

**“EXHIBIT ‘B’”**  
**Property Metes and Bounds**

Tract I: BEGINNING at a stake in the easterly margin of South Pickens Bridge road, said point of beginning being South 20 deg. 59 min. East 109.59 feet from the corner of property owned by Texie McFall; thence North 63 deg. 59 min. East 309.55 feet to an iron stake; thence South 26 deg. 01 min. East 100 feet to an iron stake; thence South 63 deg. 59 min. West 318.23 feet to an iron stake in the easterly margin of said county road; thence North 20 deg. 59 min. West and along the easterly margin of said county road, 100.39 feet to the point of beginning, containing 0.72 acres, more or less, as shown by map or plat of the Joe F. and Emma Sue Hale Farm by Joe A. Hale, County Surveyor, dated August 1, 1967, reference to which is here made. This is the same description as in the previous deed of record.

Tax Assessor's Property ID No.: Map 21F; Group B; Parcel 13.00.

Tract II: BEGINNING at an iron stake in the easterly margin of South Pickens Bridge road, said point of beginning being South 20 deg. 59 min. East 209.98 feet, more or less, from the corner of the Texie McFall property as measured along the easterly margin of said county road; thence North 63 deg. 59 min. East 318.23 feet to an iron stake; thence South 26 deg. 01 min. East 100 feet to an iron stake; thence South 63 deg. 59 min. West 326.9 feet to an iron stake in the easterly margin of said county road; thence North 20 deg. 59 min. West and along the easterly margin of said county road 100.39 feet to the point of beginning, containing 0.75 acres, more or less, as shown by map or plat of the Joe F. and Emma Sue Hale Farm by Joe A. Hale, County Surveyor, dated August 1, 1967, reference to which is here made. This is the same description as in the previous deed of record.

Tax Assessor's Property ID No.: Map 21F; Group B; Parcel 12.00.

BEING a part of the same property conveyed to Herman Glass and wife, Christine Glass (deceased) from Mrs. Ruth White Hale, et al by deed dated October 25, 1967 of record in Deed Book 408, Page 571 in the Register's Office for Washington County at Jonesborough, Tennessee, to which reference is here made.